

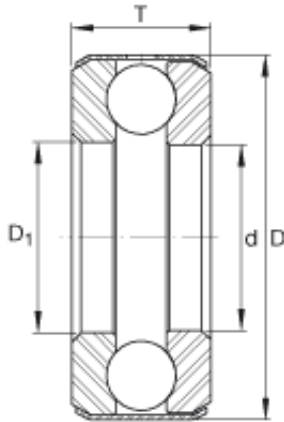

# BEARING USA CORP.



## GATES RACING TIMING BELT FOR LS CRV B18 B20 NON VTEC BLOCK B SERIES HYBRID HEAD

Bearing No. B18

B18 Bearing 2D drawings and 3D CAD models

Size	39.688x65.89x19.05 mm
Bore Diameter	39,688 mm
Outer Diameter	65,89 mm
Width	19,05 mm
d	1 9/16 inch
d	39,688 mm
D	2,594 inch
D	65,89 mm
T	0,75 inch
T	19,05 mm
D <sub>1</sub>	1,594 inch
m	0,54 lbs / Weight
m	0,245 kg / Weight
C <sub>a</sub>	9800 lbf / Dynamic load rating (axial)
C <sub>a</sub>	43600 N / Dynamic load rating (axial)
C <sub>0a</sub>	21400 lbf / Static load rating (axial)
C <sub>0a</sub>	95000 N / Static load rating (axial)
Category	Thrust Ball Bearing
Inventory	0.0
Manufacturer Name	SCHAEFFLER GROUP
Minimum Buy Quantity	N/A
Weight / Kilogram	0.25



## BEARING USA CORP.

Product Group	B00308
Rolling Element	Ball Bearing
Thrust Bearing	Yes
Single or Double Direction	Single Direction
Banded	Yes
Precision Class	ABEC 1   ISO P0
Component Description	Roller Assembly Plus Raceways
Other Features	Single Row   Deep Groove   Medium Cross Section   Grooved Race   Non Separable   Full Complement   Standard Oil Hole in Band
Long Description	1-9/16" Bore 1; 1-19/32" Bore 2; 2-19/32" Outside Diameter; 3/4" Height; Ball Bearing; Single Direction; Banded; ABEC 1   ISO P0 Precision
Inch - Metric	Inch
Category	Thrust Ball Bearings
UNSPSC	31171507
Harmonized Tariff Code	8482.10.50.08
Noun	Bearing
Keyword String	Ball Thrust
Manufacturer URL	<a href="http://www.ina.com">http://www.ina.com</a>
Manufacturer Item Number	B18
Weight / LBS	0.54
Bore 1	1.563 Inch   39.7 Millimeter
Bore 2	1.594 Inch   40.488 Millimeter
Outside Diameter	2.594 Inch   65.888 Millimeter
Overall Height with Aligning Washer	0 Inch   0 Millimeter



## BEARING USA CORP.

Height	0.75 Inch   19.05 Millimeter
--------	------------------------------